

USE: Multi-story, zero
lot line building

EQUIPMENT AT GRADE IN OPEN-AIR BUILDING ALCOVE





PURPOSE:

To provide the customer with initial information for alcove design when there are no other options for installation of Company equipment due to building on the lot line. Consultation with Company Design Services is required prior to plan finalization.

NOTES:

1. Area shall be maintained as an open air environment in front of equipment. A chain link style gate, without slats that would limit air circulation, can be installed as a means of restricting access to the area. Gates shall be made to swing open to a minimum of 180 degrees or be capable of being rolled clear of the entire alcove opening in front of Company equipment. A roll-up style door in front of the equipment is not acceptable.
2. All walls surrounding equipment, top, sides and floors shall be three hour fire rated, and shall be of concrete or masonry construction. Exterior wall adjacent to and extending ten feet from perimeter of the opening shall have a three hour fire resistance rating and be of concrete or masonry construction.
3. A minimum of 25 foot wide driveable area shall be maintained in front of the alcove to allow for crane set-up for installation and maintenance of Company equipment.
4. A minimum of 30 feet vertical clearance from finished grade to lowest point of structure is required.
5. A minimum alcove dimension of 42 feet wide by 15 feet deep is required to allow for proper clearance of equipment from the building and to assist with installation and maintenance. Verify alcove dimensions with Design Services in order to accommodate all Company equipment within this space, additional area may be required.
6. A ten foot minimum work area is required in front of Company equipment. Work areas allowed for operating personnel are alleys, sidewalks or parking areas with a minimum depth or width of ten feet that can be restricted. Driveways or streets are not considered acceptable work areas.
7. Equipment location and clearances shall be determined by Design Services and provided on the approved Construction Drawing. Minimum clearances provided on this standard must be maintained.
8. Any Public Utility equipment that will be installed within this alcove shall not be taller than 3 feet and the required 3 foot of separation from Company equipment must be maintained. Coordinate with Design Services before placing any non-Company owned equipment within this space and verify that easements allow for this placement.
9. Refer to SR-108 for easement requirements.

 Tucson Electric Power	 SANTA CRUZ COUNTY	INITIATED BY	JAB	REVISION NO.	0	SR-243 Pg. 1 of 2
		ESR COMM.	7-23	ESR COMM.	-	
				EFFECTIVE DATE	7-23	

USE: MULTI-STORY,
ZERO LOT LINE
BUILDING

EQUIPMENT AT GRADE IN OPEN-AIR BUILDING ALCOVE

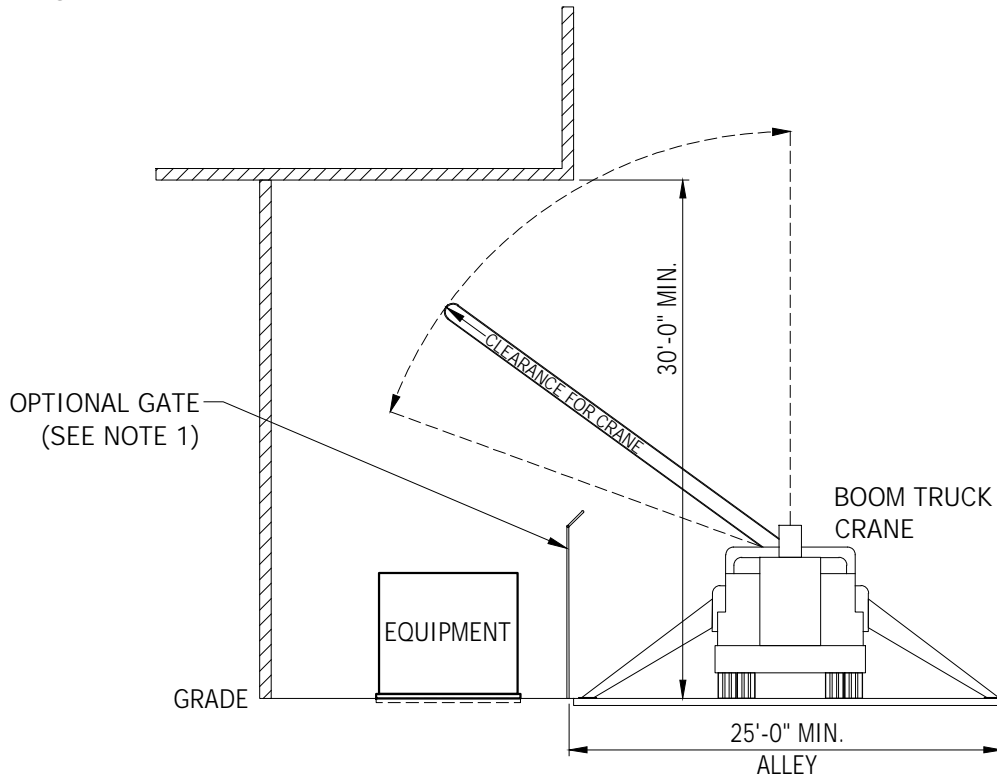

ALCOVE ELEVATION VIEW

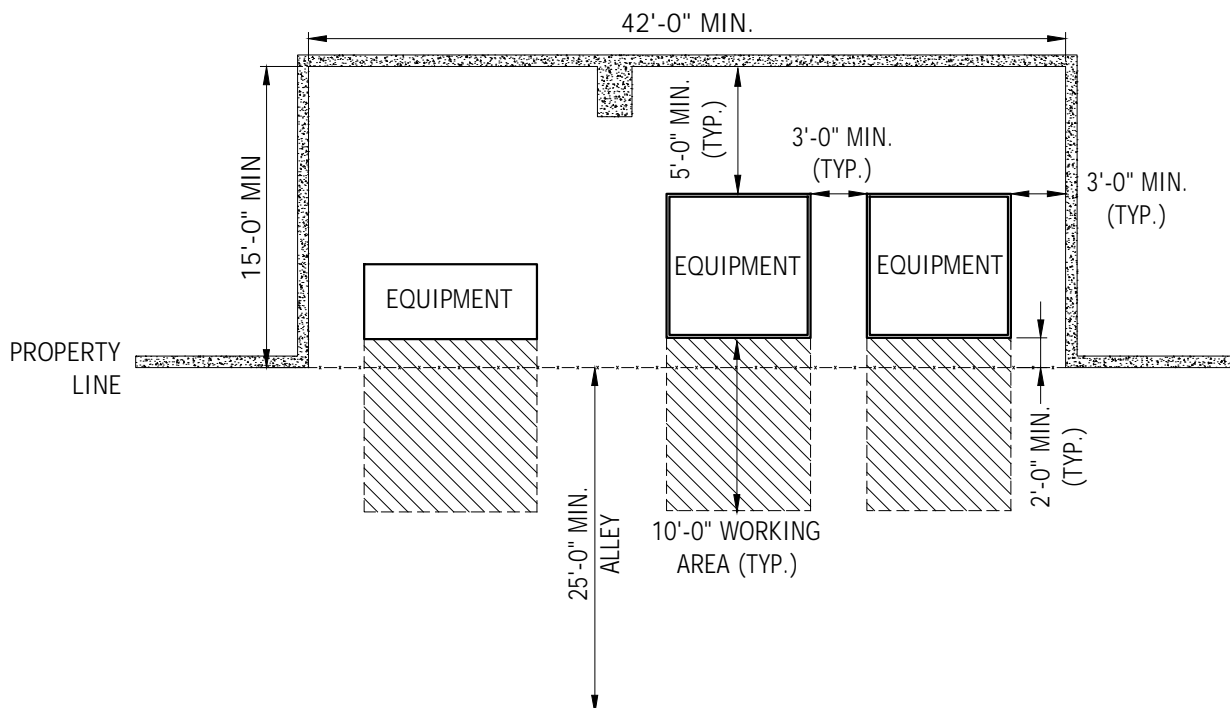

ALCOVE PLAN VIEW