

APPLICATION FOR SERVICE



Type of Service & Limitations

Upon the customer's request, the Service Provider will specify the type of distribution service available (voltage and number of phases) at any given location for utilization by the customer. Service shall be provided through one service connection at one point of delivery for each unique customer premise. Customers with facilities requiring more than one service voltage are responsible for providing those additional voltages through their own means (e.g. step-down transformers). Customers with loads exceeding the limits defined below may be required to receive primary metered service. The electric energy furnished will be alternating current 60 hertz, single or three-phase at one of the following standard nominal voltages, subject to the limitations shown:

Single-Phase (Residential & General Service or Light and Power Customers)

120 volts, 2-wire (30A maximum service entrance size) is no longer available for new service and is for maintenance only. 120/240 volts, 3-wire from pole mounted transformer is limited to 100kVA maximum load and/or 600A maximum service entrance size. 120/240 volts, 3-wire from pad-mounted transformer is limited to 167kVA maximum load and/or 800A maximum service entrance size. Loads of 530A or more will require 2-4 inch duct systems for parallel service conductor.

Three-Phase (General Service or Light and Power Customers)

240/120 volt, 4-Wire Delta: Is no longer available for new service and is for maintenance only or an upgrade of an existing three-phase service per limitations for OH and UG service. This voltage is not available from Company's underground distribution system. When available, service is limited to 600A maximum service entrance size for underground service from pole mounted transformers and to 1200A maximum service entrance size for overhead service from pole mounted transformers.

208Y/120 volt, 4-Wire: Limited to 3000A maximum service entrance size for underground service from a pad mounted transformer, limited to 1600A maximum service entrance size for overhead service from pole mounted transformers, and limited to 600A maximum service entrance size for underground service from pole mounted transformers. Not available for service to mobile home lots per NEC 550-21.

480Y/277 volt, 4-Wire: This service will also be provided for all 480 volt three-phase, three-wire services unless otherwise specified by Service Provider. Limited to 4000A maximum service entrance size for underground service from a pad mounted transformer, limited to 800A maximum service entrance size for overhead service from pole mounted transformers, and limited to 600A maximum service entrance size for underground service from pole mounted transformers.



The maximum size for customer owned underground service conductors to Company's equipment is 600kcmil.

TEP:

4,160/2,400 volt, 4-Wire: Primary metered service available only at TEP's option.*

13,800Y/7,970 volt, 4-Wire: Primary metered service available only at TEP's option.*

UES:

13,200/7,620 volt, 4-Wire: Primary metered service available only at UES's option.*

*Refer to SR-451 for primary metered service requirements.

APPLICATION FOR SERVICE

Temporary Service

The Service Provider will install temporary service to a customer providing the customer pays the estimated installation and removal cost as well as the normal monthly billings on the electric meter. It is imperative that the customer make application for temporary service by calling TEP at (520) 918-8300 or UES at (520) 761-7951 at the earliest possible time as any jobs requiring a meter and service will fall into our normal construction schedules. The installation and removal cost must be paid prior to the release of the job for construction. For details on the overhead and underground temporary services, please refer to the appropriate SR standards.

Notice to Applicants

TEP

The default Pricing Plan for Temporary Service and Commercial Service is GS-10. The default Pricing Plan for Residential Service is R-01.

UES Santa Cruz

The default Pricing Plan for Temporary Service and Commercial Service is EGSGS. The default Pricing Plan for Residential Service is ERRES.

For services other than Temporary, Commercial, and Residential, please consult the Pricing Plans listed at tep.com or uesaz.com. Upon application for service or upon request, the applicant or customer will select the applicable Pricing Plan best suited to his or her requirements. The Company may assist in making this election, but will not be held responsible for notifying the Customer of the most favorable Pricing Plan, and will not be required to refund the difference in charges under different Pricing Plans.



Preliminary Notification

To aid architects and engineering firms in providing the Company with advance notification and preliminary engineering data and to obtain the location from which a new building will be served, these firms should submit plans for new buildings and projects with a New Construction Application. This will enable the Service Provider to provide more complete information with minimal delay to these firms and eliminate some of the problems in the early facilities design stage. This form does not supersede the Company's present application requirements, but is a supplemental aid.

Obtaining Service

In order to obtain service at the time desired, application should be made as early as possible. There are no fees for making an application. An appropriate Governmental Agency electrical permit must be obtained and the permit number submitted with the New Construction Application. It is important to keep the Company informed as to the progress of the project and anticipated date that service will be needed. See SR-104 for TEP and UES New Construction Applications.

FORMERLY SR-1.05 & SR-1.06

		INITIATED BY	GC	REVISION NO.	3	SR-104  Pg. 2 of 9
		ESR COMM.	8-06	ESR COMM.	9-18	
				EFFECTIVE DATE	9-18	

Tucson Electric Power
Residential / Commercial New Construction Application

PLEASE PRINT

Date: _____ Permit No: _____

Required date: (date you need power): _____

A. Official Address Information

Official Service Address: _____

City: _____ Zip Code: _____

Lot#: _____ Subdivision Name: _____

Legal: T _____ R _____ S _____ Q _____

B. Responsible Party for Billing- Residential

Primary Name: _____ Telephone#: _____

Spouses Name: _____

Mailing address: _____

Social Security number: _____ Driver's License: _____

Employer: _____ Address: _____

Telephone#: _____ Other TEP accounts: _____

C. Responsible Party for Billing- Commercial

Business Name: _____ Primary Number: _____

Business Type: Corp: _____ Partnership: _____ LLC: _____ Sole Proprietor: _____

Officer/Partner/Owner Name _____

(Person with Authority to Accept Financial Responsibility for the Account)

Phone Number for above: _____ Tax ID: _____

Mailing address: _____

D. Contact Information

Site Contact Name: _____ Telephone#: _____

Company Name: _____ Cellular #: _____

Company Address: _____ Pager #: _____

E. Electrical Information

Type of Service:

New Service: _____ Increase: _____ Temporary: _____ Relocation: _____ Removal: _____

Underground (UG): _____ or Overhead (OH) _____ Voltage _____

Single Phase: _____ or Three Phase _____ Amperage: _____

Power kill required: Yes _____ No _____ Unknown _____ Building Square footage _____

☐ Solar Installation ☐ Electric Vehicle

Cooling & Heating Equipment:

A/C Tonnage: _____ or Evap: _____

Heat pump tonnage: _____ or Gas: _____

F. Additional Information: _____

NOTICE TO APPLICANTS:

THE DEFAULT PRICING PLAN FOR TEMPORARY SERVICE AND COMMERCIAL SERVICE IS GS-10. THE DEFAULT PRICING PLAN FOR RESIDENTIAL SERVICE IS R-01. FOR SERVICES OTHER THAN TEMPORARY, COMMERCIAL, AND RESIDENTIAL, PLEASE CONSULT THE PRICING PLANS LISTED AT TEP.COM.

BE SURE TO SEND A COPY OF THE OFFICIAL ADDRESS AND LEGAL DESCRIPTION OF THE PROPERTY TO DESIGN SERVICES.

- IF 1 ACRE PARCEL OR LARGER, ALSO SEND SITE PLAN
- IF OVER 200 AMPS, ALSO SEND ELECTRICAL PLANS.
- BE SURE TO OBTAIN THE PROPER GOVERNMENTAL PERMITS
- UPON RECEIPT OF ALL ABOVE INFORMATION, THE AREA FIELD TECH OR DESIGNER WILL CONTACT YOU WITHIN 5 WORKING DAYS

Mail To:

Design Services
P.O. Box 711 Mail Stop OH202
Tucson, Arizona 85702
Fax # 520-917-8794

Governmental Agencies

City of South Tucson (520) 792-2424 Town of Marana (520) 382-2600
City of Tucson (520) 791-5550 Town of Oro Valley (520) 229-4800
Pima County (520) 740-6490 Town of Sahuarita (520) 822-8866

*Az. Dept. of Manufactured Housing (520) 628-6920

(*Manufactured Homes require City/County and State Clearances)

FORMERLY SR-1.13



INITIATED BY

GC

REVISION NO.

7

ESR COMM.

8-06

ESR COMM.

9-18

EFFECTIVE DATE

9-18

SR-104

Pg. 3 of 9



ELECTRICAL NEW CONSTRUCTION APPLICATION - RESIDENTIAL

Kingman: ph 928-681-8922 Fax 928-681-8920
2498 Airway Ave, Kingman, AZ 86409

Lake Havasu: ph 928-505-7016 Fax 928-505-7032
2749 Maricopa Ave, Lake Havasu City, AZ 86406

Nogales: ph 520-761-7951 fax 520-761-7947
861 W Mariposa Rd, Nogales, AZ 85621 Toll
Free: 877-UES-4YOU (837-4968)

Applicant Information

Full Name: Last _____ First _____ Middle Initial _____

Business Name (If Applicable) _____

Mailing Address _____ City _____ State _____ Zip _____

Home Phone _____ Work Phone _____

Cell or Message Phone _____ Employer Name _____

Social Security No _____ Driver's Lic No/State _____

Nearest Relative _____ Phone _____ Relationship _____

Date (estimate) for when you need power: Month _____ Day _____ Year _____

Spouse Information (If no spouse, please write None)

Spouse Name _____ Work Phone _____

Social Security No _____ Employer Name _____

Service Location Information

Service Address _____ Cross Street _____ City _____ Zip _____

Legal Description: Tract _____ Block _____ Lot _____ Subdivision _____ Township _____ Range _____ Section _____ ☐ City ☐ County

Is this property zoned A-R Agricultural – Residential? Yes _____ or No _____ (Mark one)

If yes, will there be more than one residential dwelling on this property? Yes _____ or No _____ (Mark one)

Parcel No: (Example: 310-06-025) _____

Type of Residence: ☐ House ☐ Mobile Home ☐ RV/Other: _____

Livable Square Footage: _____ **AMPS:** ☐ 100 ☐ 200 ☐ Other: _____

If structure is a manufactured building, date it will be moved into: _____

Type(s) of Service: ☐ Permanent Construction ☐ Dusk to Dawn Light ☐ Underground
☐ Temporary Construction ☐ Non-Permanent (RV) ☐ Overhead
☐ Service Upgrade ☐ Change in Service

Note: The residential temporary construction fee will be determined by the Engineering Department. Other rules and fees may apply according to the Rules and Regulations approved by the Arizona Corporation Commission. "Electric Service Installation Requirements" booklets available online at www.uesaz.com, by mail or in local office.

Builder/Contractor/Manufactured Home Dealer _____ Phone _____

Electrician _____ Phone _____

Note: UniSource requires the Applicant to complete this Application and submit a plot plan. The Applicant is responsible for notifying UniSource when service pole and service entrance are installed and ready for service (City, County and/or State Inspections may be required prior to connection). A security deposit is required when meter is set or, in lieu of a cash deposit, a letter of credit from a previous electric utility company may be submitted. Established good credit with UniSource Energy Services is also acceptable.

Signature _____ Date _____



INITIATED BY

ED

REVISION NO.

0

SR-104

ESR COMM.

9-18

ESR COMM.

-

Pg. 4 of 9

EFFECTIVE DATE

9-18

ELECTRICAL NEW CONSTRUCTION APPLICATION - RESIDENTIAL
(Plot Plan)

Legal Description: Township _____ Range _____ Section _____
Subdivision _____
Block _____ Lot _____ Parcel _____
Address _____

Please enter the following Information:

1. Property boundary dimensions, dimensions of all existing and proposed structures, and distances between all buildings.
2. Location of public utility easement(s).
3. Location of septic tank(s) and leach field(s).
4. Location of proposed service entrance.

Rear Lot Line

Front Lot Line

Front Street

Indicate North

ELECTRICAL NEW CONSTRUCTION APPLICATION - RESIDENTIAL

(Plot Plan Example)

Legal Description: Township 10N Range 10W Section 10
 Subdivision Sunny Arizona Ranchos, Unit 10
 Block 10 Lot 10 Parcel 111-22-333
 Address 1010 Your Property Street

Please enter the following Information:

1. Property boundary dimensions, dimensions of all existing and proposed structures, and distances between all buildings.
2. Location of public utility easement(s).
3. Location of septic tank(s) and leach field(s).
4. Location of proposed service entrance.

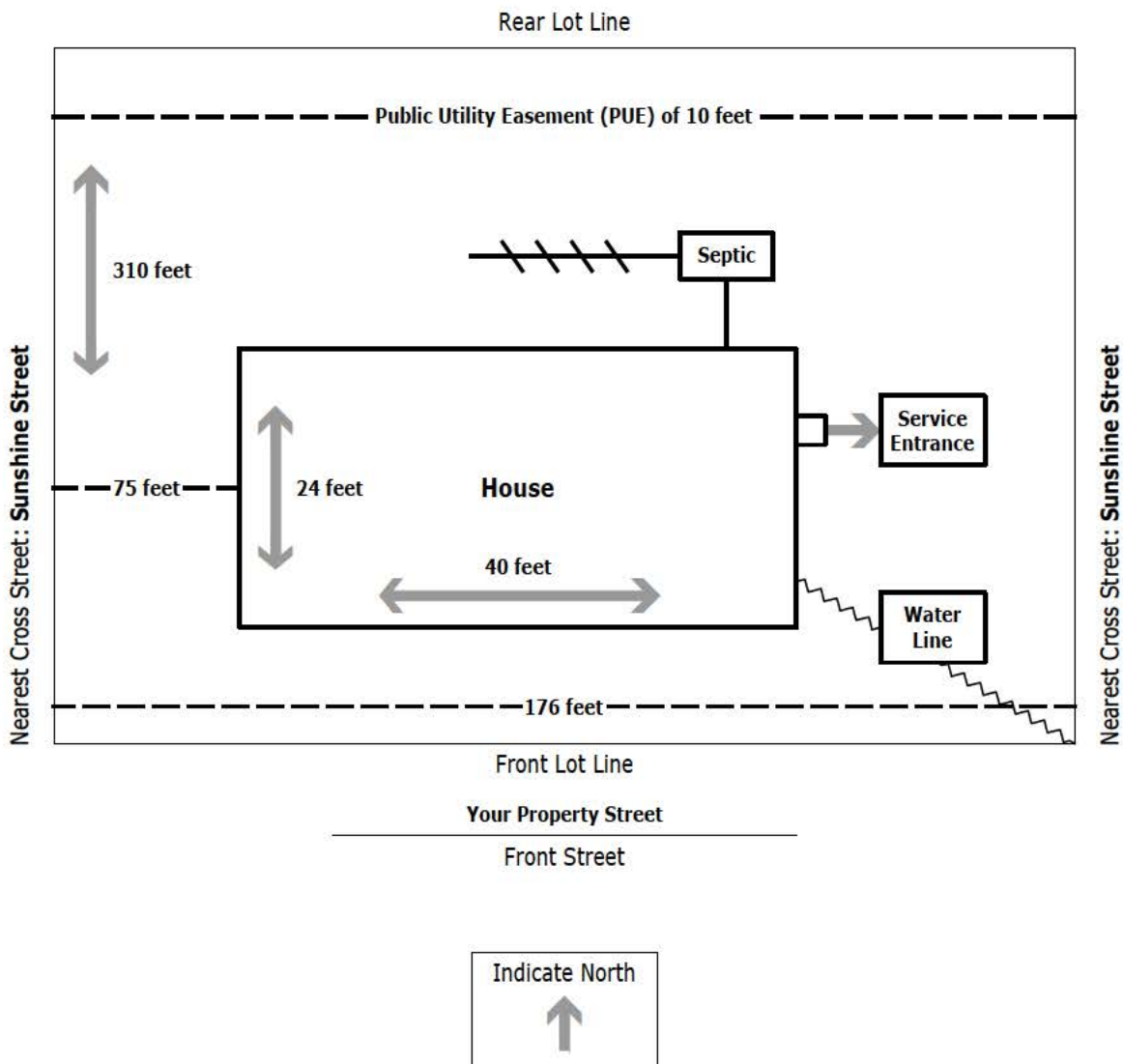

ELECTRICAL NEW CONSTRUCTION APPLICATION - COMMERCIAL

Kingman: ph 928-681-8922 Fax 928-681-8920
2498 Airway Ave, Kingman, AZ 86409

Lake Havasu: ph 928-505-7016 Fax 928-505-7032
2749 Maricopa Ave, Lake Havasu City, AZ 86406

Nogales: ph 520-761-7951 fax 520-761-7947
861 W Mariposa Rd, Nogales, AZ 85621 Toll
Free: 877-UES-4YOU (837-4968)

Applicant Information

Business Name _____ C/O _____

Responsible Party or Owner _____

Work Phone _____ Message Phone _____

Cell Phone _____ Social Security No. _____

Mailing Address _____ City _____ State _____ Zip _____

Billing Address _____ City _____ State _____ Zip _____

Date (estimate) for when you need power: Month _____ Day _____ Year _____

Business Information

☐ Partnership ☐ Corporation ☐ Sole Owner ☐ Other: _____

Tax ID No. _____ Type of Business _____

Service Location Information

Service Address _____ Cross Street _____ City _____ Zip _____

Legal Description:

Tract _____ Block _____ Lot _____ Subdivision _____ Township _____ Range _____ Section _____ ☐ City ☐ County

Parcel No: (Example: 310-06-025) _____

AMPS: ☐ 100 ☐ 200 ☐ Other: _____

If structure is a manufactured building, date it will be moved into: _____

Square Footage _____ Voltage _____

Type(s) of Service: ☐ Permanent Construction ☐ Dusk to Dawn Light ☐ Underground
☐ Temporary Construction ☐ Non-Permanent (RV) ☐ Overhead
☐ Service Upgrade ☐ Change in Service

Note: The commercial temporary construction fee will be determined by the Engineering Department. Other rules and fees may apply according to the Rules and Regulations approved by the Arizona Corporation Commission. "Electric Service Installation Requirements" booklets available online at www.uesaz.com, by mail, or in the local office. All services must meet E.U.S.E.R.C. (Electric Utility Service Equipment Requirements Committee) standards.

Builder _____ Phone _____

Electrician _____ Phone _____

Note: UniSource requires the Applicant to complete this Application and submit a site plan and electrical load requirements. The Applicant is responsible for notifying UniSource when service pole or service entrance is installed and ready for service (City, County and/or State Inspections may be required prior to connection). A security deposit is required, and the amount will be determined prior to meter set. In lieu of a deposit, a Surety Bond may be submitted.

Signature _____ Date Requested _____



INITIATED BY

ED

REVISION NO.

0

SR-104

ESR COMM.

9-18

ESR COMM.

-

Pg. 7 of 9

EFFECTIVE DATE

9-18

ELECTRICAL NEW CONSTRUCTION APPLICATION - COMMERCIAL
(Plot Plan)

Legal Description: Township _____ Range _____ Section _____
Subdivision _____
Block _____ Lot _____ Parcel _____
Address _____

Please enter the following Information:

1. Property boundary dimensions, dimensions of all existing and proposed structures, and distances between all buildings.
2. Location of public utility easement(s).
3. Location of septic tank(s) and leach field(s).
4. Location of proposed service entrance.

Rear Lot Line

Front Lot Line

Front Street

Indicate North

ELECTRICAL NEW CONSTRUCTION APPLICATION - COMMERCIAL

(Plot Plan Example)

Legal Description: Township 10N Range 10W Section 10
 Subdivision Sunny Arizona Ranchos, Unit 10
 Block 10 Lot 10 Parcel 111-22-333
 Address 1010 Your Property Street

Please enter the following Information:

1. Property boundary dimensions, dimensions of all existing and proposed structures, and distances between all buildings.
2. Location of public utility easement(s).
3. Location of septic tank(s) and leach field(s).
4. Location of proposed service entrance.

